

Use & maintenance

- SC3500GO

ATTENTION! Do not use the machine before you have read and understood the Instructions for User Manual



1a. Disconnect battery charger and store the cable.



1b. Disconnect the battery charger cable from the mains electricity supply.



2. Fill the solution tank with fresh water. The fresh water temperature must not exceed 40 °C.



3. Solution level indicator is on the side of the tank shows current level.



3. If the squeegee is not connected to the machine: install and fasten it by using the two knobs, then connect the suction hose.



4. Adjust squeegee angle and blade pressure for optimal water pick-up by turning the adjustment knob on the support.



5. Place the brush or the pad-holder under the deck and install it manually. Use the appropriate brush to clean the floor.



6. Insert the operator key and start the machine. Lower the brush by pressing the brush button.



7. Push the drive pedal to start cleaning. Adjust the maximum forward speed by the speed potentiometer. For the reverse mode press the R on the control panel.



8. Adjust (if needed) the solution flow level according to the cleaning performance and application.



10. **Once you have finished cleaning** empty the recovery tank with the hose. Then empty the solution tank with the transparent hose.



11. Wash with fresh water the recovery tank and the vacuum grid.



12. Press the click-off button and wait for the brush/pad holder to fall on the floor.



13. Remove to clean or change brush.



14. Take the squeegee off and remove debris. Check and clean the squeegee blades.



15. Clean the machine using a damp cloth and where needed use a neutral cleaning product.



16. Charge the batteries: Connect the battery charger cable to the electrical socket.



17. Park the machine with the recovery tank cover open.

If the machine has been used until the Red light illuminates on the battery level indicator on the machine, a full recharge of the batteries (10-12 hours) will be required. Failure to carry out this procedure may cause damage to the batteries. Charging the batteries after every use is recommended.

Troubleshooting

- SC3500GO

ATTENTION! Do not use the machine before you have read and understood the Instructions for User Manual

The machine doesn't work as it should?



- 1 Check if the power cable is correctly connected.
- 2 Check if the battery is charged.

The suction doesn't work as it should?



- 1 Check if the suction hose is correctly installed and clean.
- 2 Open the recovery tank and check if the vacuum grid and gasket are clean.
- 3 Check if squeegee blades are damaged or dirty.
- 4 Close the recovery tank cover properly and/or verify the gasket wear.

The machine doesn't clean as it should?

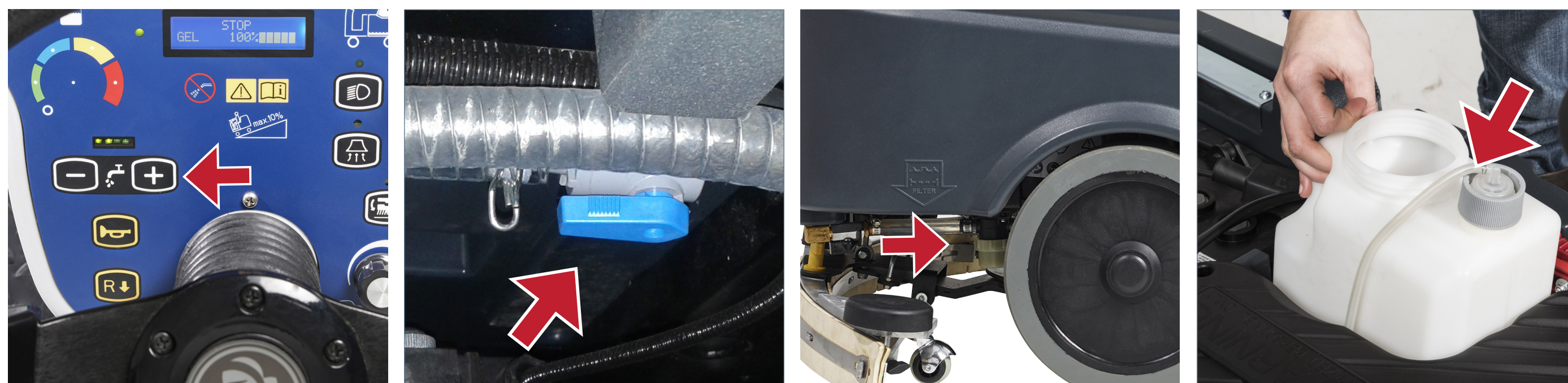

- 1 Check if you have the right water settings.
- 2 Check if the solution valve is open.
- 3 Check if the solution filter is clean.
- 4 Check the EcoFlex™ system is cleaned, eventually purge the system.

The brush don't work as they should?



- 1 Check if the brush are correctly installed and not worn out.
- 2 Check if there isn't any brush motor overload i.e. 3 LED lights flashing simultaneously.